

EXISTING FLOOR LAYOUTS  
SCALE 1:50

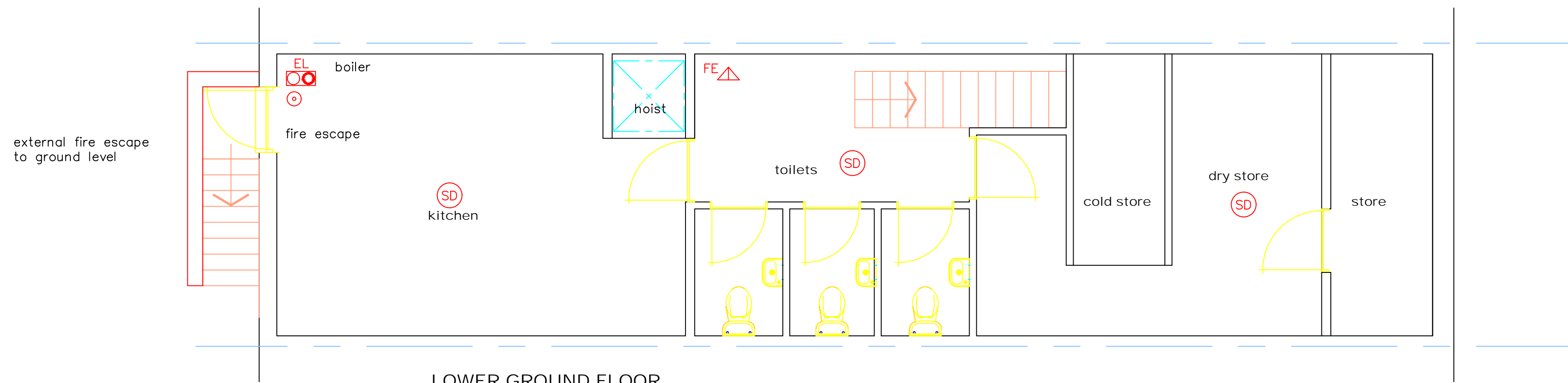

LOWER GROUND FLOOR

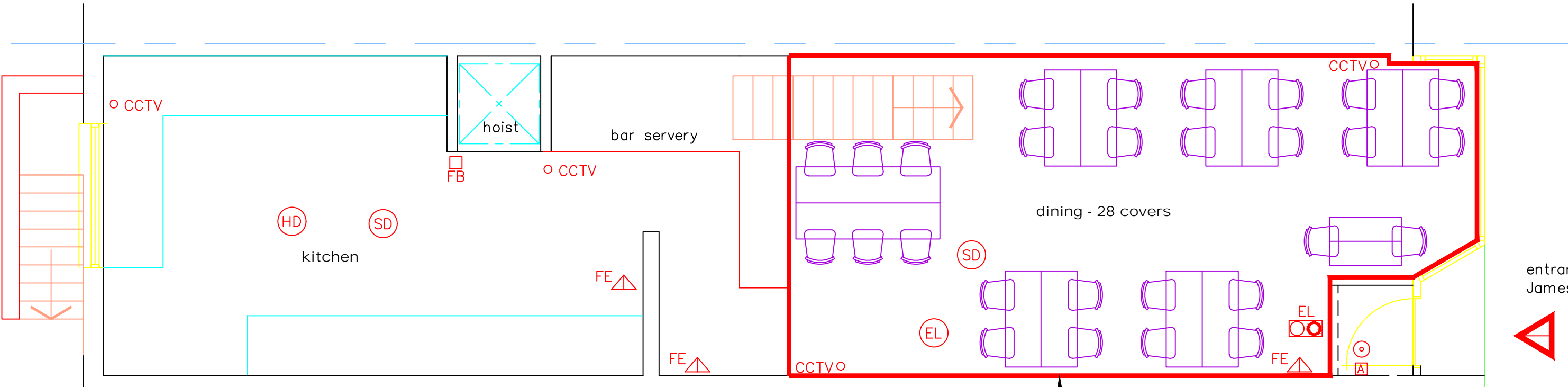

GROUND FLOOR

KEY:

- Blockwork
- External brickwork
- Timber/metal framed stud walling
- Mains Powered Extract Fan
- Mains Powered interconnecting smoke detectors
- SVP Soil & vent pipe
- SS Stub stack
- RWP Rain water pipe
- Spot levels
- 30 minute fire door
- Manual fire alarm call point
- Illuminated fire exit sign c/w emergency light
- Fire alarm panel
- Mains Powered interconnecting heat detectors
- Emergency Light
- CCTV Camera
- Fire Blanket
- Fire Extinguisher

NOTES:  
The design and construction of this project shall be in accordance with the current Building Regulations & NHBC Standards. These notes & drawings have been prepared solely for the purpose of Planning & Building Regulation approval.  
  
Do not scale from this drawing unless for Planning purposes. All dimensions to be checked on-site and any alterations to be approved by the Architect and/or client prior to any work commencing.  
  
**Ordnance Survey Licence No: 100047591**  
  
This drawing to be copyright and to be read in conjunction with all other drawings

Ammendments:  
  
Rev A: General amendments to suit site conditions – 13/12/23

Key:

Client Name & Address:  
  
119 St James's Street  
Brighton  
BN2 1TH

Project Address:  
  
119 St James's Street  
Brighton  
BN2 1TH

Drawing Details:  <u>ALCOHOL LICENCE DRAWING</u>  Existing Layouts		
Project No: 1006	Drawing No: 1	Rev No: A
Scale: 1:100 @ A2	Drawn: BWH	Date: 05/12/23



**B H ARCHITECTURE Ltd**  
Heath Cottage  
Newlands Lane  
Purbrook  
Waterlooville  
Hants  
PO7 5SQ  
Tel: 023 9223 2322  
Mob: 07747 771808  
E-mail:bernard@bernardharding.com

